

Descendants of Thomas Maher

Compiled by
Michael F. McGraw, Ph.D.
mfmcgraw@austin.rr.com
Revised: April 4, 2018

Introduction

The initial Maher family information was shared by Gay Young on the Co. Tipperary Internet list on March 8, 2009 under the title: "Maher - Connors - Kinney - Coonan - Ryan." This document is referenced as "Gen." All three of Thomas Maher's sons left Ireland and settled in central New York, in the town of Pompey in Onondaga County. Although Cornelius, Thomas and John Maher are described as siblings according to the "Gen" document no evidence has been uncovered so far to prove that relationship nor has any information been found that shows their father was named Thomas. The birthplace of son Thomas in Co. Cork is also suspect. Mary O'Donnell isn't necessarily connected to the Upperchurch area since she met and married Thomas Maher in Pompey, NY. It's possible that she was born in Co. Cork and by association that might be how Thomas Maher's birthplace also became Co. Cork.

Where questions still persist with information from the above document (Gen), they are highlighted.

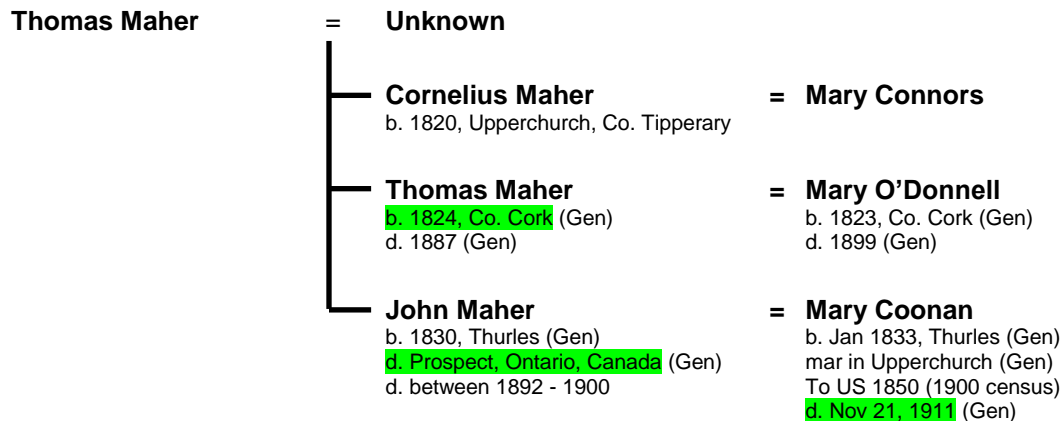

Mary Connors' marriage to Cornelius Maher was her second marriage. Her maiden name was Ryan and she married Patrick Connors on March 3, 1835 at Borrisoleigh, Glenkeen parish. Patrick died sometime before 1845 and Mary Ryan Connors married a second time to Cornelius Maher on February 2, 1845 at Borrisoleigh. Her son Thomas Connors married Maria Ryan in Pompey, NY while her daughter from her second marriage, Bridget Maher, married Roger Ryan of Cuyler, Cortland County and later, after Roger's death, she married another Upperchurch area man, James Coonan.

Thomas Maher's (b. 1824) wife's name was Mary O'Donnell. John Maher's obituary has not been found and his death in Ontario, Canada seems out of place for a man who spent most of his life in Pompey, NY. The names of the children of Thomas Maher and Mary O'Donnell given by the "Gen" document are found in the Pompey census records. However, there were only two daughters; Bridget (b. 1863, Pompey) is actually Sarah Bridget (b. Sept 1862, Pompey).

Mary Coonan and her husband John Maher settled in Pompey, NY in 1850. She was followed by her brothers James in 1852, John in 1855 and sister Honora by 1863. The children of John Maher and Mary Coonan found in the “Gen” document are correct in names and number but the birth order and birth years had to be corrected via census data.

The Thomas Maher Connections

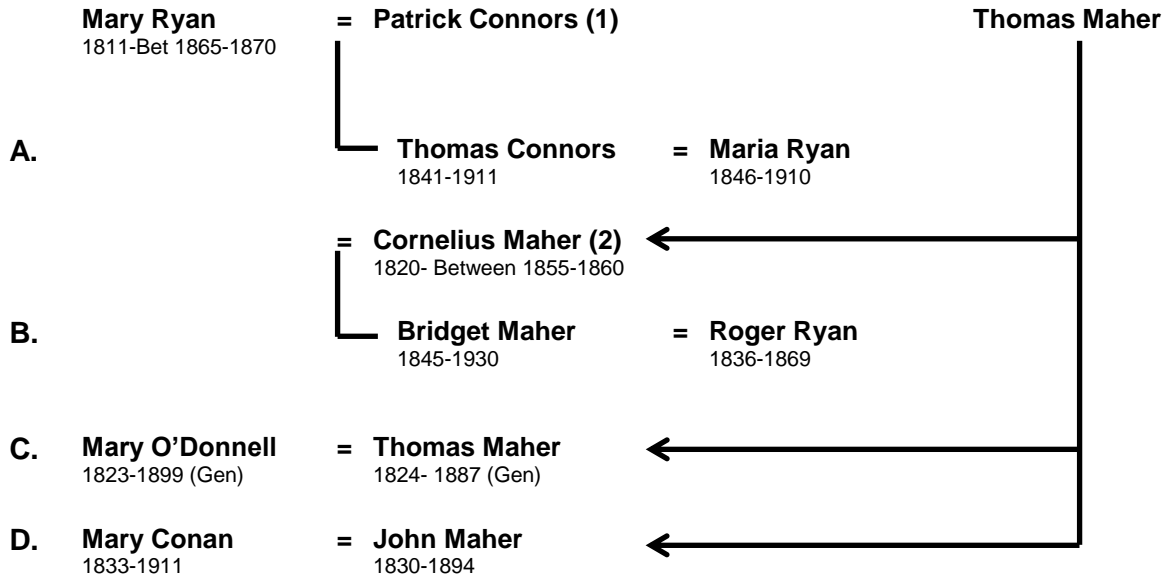

Document	Title
A.	The Connors and O'Brien Families
B.	The Roger Ryan Family of Cuyler
C.	The O'Donnell Families
D.	The Conan Family of Foilagoule, Moyaliff, Co. Tipperary

Cornelius Maher married Mary Ryan Connors who had given birth to three children in her first marriage to Patrick Connors. Mary and Cornelius married in Ireland in 1845 and had two children in Ireland. They had a final child in Pompey in 1853 after arriving in the US. Mary had a history in Ireland and it was possible to find records of both of her marriages and the baptisms of her children. It was also possible to find the Connors/Maher land holding in the townland of Fantane, Glenkeen parish, Co. Tipperary, Ireland.

Thomas Maher found his future wife, Mary O'Donnell in Pompey, NY and left no trace in the Irish records.

John Maher married Mary Coonan in Ireland although no marriage record has been found. They didn't have any children until after they settled in Pompey, NY

Mary Ryan and Patrick Connors (1); Cornelius Maher (2)

(d/o Father and Mother)

(s/o Father and Mother) #1

(s/o Thomas Maher and Mother) #2

Mary Ryan

b. 1811, Ireland (1865 census)
mar Mar 3, 1835, Borrisoleigh
Wit Phill Connors and Ellen Ryan

Maria Ryan is the younger
sister of Roger Ryan (1)

Patrick Connors (1)

Nanno Connors

bap Oct 19, 1838, Fantane, Glenkeen par
Sps John Dwyer and Biddy Quinlan

Thomas Connors

bap Mar 30, 1841, Fantane, Glenkeen par
Sps Ellen Ryan

= Maria Ryan

b. Jul 1846, Ireland
mar 1868
To US 1851

Patrick Connors

Bap Feb 19, 1844, Fantane, Glenkeen par
Sps Matty Ryan and Ellen Dwyer

= Cornelius Maher (2)

b. 1820, Upperchurch, Co. Tipperary
mar Feb 2, 1845, Borrisoleigh
Wit Con Maher and Mary Kennedy

Bridget Maher

bap Dec 25, 1845,
Borrisoleigh, Glenkeen par
Sps Ellen Ryan

= Roger Ryan (1)

b. 1837, Upperchurch
d. Dec 22, 1869, Pompey, NY

Mary Ann Ryan

b. 1868, NY
d. Dec 15, 1940,
Pompey, NY
bur Pompey Cem,
Pompey, NY

= Jeremiah Conan

b. July 20, 1863, NY
d. Jun 28, 1941, Syracuse, NY
bur Pompey Cem, Pompey, NY

Roger A. Ryan

b. Dec 1, 1869 Truxton
d. Feb 18, 1946 Tully
2nd cousins

= Mary E. Young

b. 1881
mar Nov 29, 1899
d. 1940

= James Conan (2)

b. Dec 9, 1830, Foilagoule, Moyaliff
d. Jul 2, 1905

James Conan was the son of
Jeremiah Conan and Winifred
Walsh. and the father of
Jeremiah Conan

Margaret Maher

Bap Jun 29, 1848, Borrisoleigh,
Glenkeen par
Sps Catherine Ryan

Emma Maher

b. 1853, Onondaga Co., NY

A record of the marriage of Roger Ryan and Bridget Maher was not found in the Upperchurch area of Co. Tipperary, Ireland or in the Cuyler-Truxton area of Cortland Co., NY. A baptism record of Bridget Maher was found in Borrisoleigh, Co. Tipperary. A Marriage record for Bridget's parents: Cornelius Maher and Mary Connors was also found in Borrisoleigh. There is evidence in the 1855 and 1865 Pompey census records that Bridget's parents came to the US in 1851.

Borrisoleigh RC Parish Records

Marriage

March 3, 1835 - Paddy Connors and Mary Ryan - Borrisoleigh RC parish
Curraghkeal, Wit Phill Connors and Ellen Ryan

Baptisms

October 19, 1838 - Nanno Connors - par. Paddy Connors and Mary Ryan - Borrisoleigh RC par
Fantane, Sps. John Dwyer and Bidy Quinlan.

March 30, 1841 - Thomas Connor, par. Patrick Connors and Mary Ryan - Borrisoleigh RC par
Fantane, Sps. Ellen Ryan.

February 19, 1844 - Patrick Connors, par. Patk Connors and Mary Ryan - Borrisoleigh RC par
Fantane, Sps Matty Ryan and Ellen Dwyer.

Marriage

February 2, 1845 - Cornelius Maher and Mary Ryan married by Rev. Wm. Morris, Borrisoleigh
Fantane, Wit Con Maher and Mary Kennedy

Baptisms

December 25, 1845 - Bridget Maher, par. Connor Maher and Mary Ryan - Borrisoleigh RC par
Fantane, Sps. Ellen Ryan

June 29, 1848 - Margaret Maher, Par. Con Maher and Mary Ryan - Borrisoleigh RC Par
Fantane, Sps. Catherine Ryan.

Fantane is now Fantane North (161 acres, 0.25 mi²) and Fantane South (185 acres, 0.29 mi²)
It is located in Glenkeen civil parish, Kilnamanagh Upper barony. Curraghkeel is on the east side
of Fantane South

Fantane is located 4.5 km northwest of Borrisoleigh; 4.0 km east of Templeberry and 7.0 km
north of the village of Upperchurch.

Griffith's Valuation

24		PRIMARY VALUATION OF TENEMENTS.							
		PARISH OF GLENKEEN.							
FANTANE, NORTH (Ord. Ss. 23 & 34.)									
1	A	Martin Tracy, . . .	Silver Oliver, Esq. . .	Land,	4 3 13	2 15 0	—	2 15 0	
—	B	a	Martin Tracy, . . .	Silver Oliver, Esq. . .	House, offices, and land,	32 0 30	17 5 0	2 0 0	19 5 0
2	A	Bridget Connor, . . .	Silver Oliver, Esq. . .	Land,	35 2 1	18 10 0	—	18 10 0	
—	B	Bridget Connor, . . .	Silver Oliver, Esq. . .	Land,	3 1 8	1 15 0	—	1 15 0	
—	C	a	Bridget Connor, . . .	Silver Oliver, Esq. . .	House, offices, and land,	6 3 14	3 15 0	1 10 0	5 5 0
—	A	Philip Dwyer, . . .	Bridget Connor, . . .	House, offices, & garden,	0 0 25	0 1 0	1 0 0	1 1 0	
—	B	a	Margaret Maher, . . .	Silver Oliver, Esq. . .	House and garden, . . .	0 1 37	0 5 0	0 10 0	0 15 0
—		b	Patrick Dwyer, . . .	Silver Oliver, Esq. . .	House and garden, . . .	0 1 28	0 5 0	0 5 0	0 10 0
3			James Connor, . . .	Silver Oliver, Esq. . .	House and land, . . .	16 2 7	8 0 0	1 0 0	9 0 0
4			Mary Leahy, . . .	Silver Oliver, Esq. . .	House and land, . . .	16 0 36	8 10 0	1 0 0	9 10 0
5			Roger Hogan, . . .	Silver Oliver, Esq. . .	Land,	11 2 15	6 5 0	—	6 5 0
6			Philip Dwyer, . . .	Silver Oliver, Esq. . .	Land,	18 2 7	10 0 0	—	10 0 0
—		a	Vucanu, . . .	Philip Dwyer, . . .	House and office, . . .	—	—	1 0 0	1 0 0
—		b	Cornelius Maher, . . .	Silver Oliver, Esq. . .	House and land, . . .	11 1 13	6 10 0	0 15 0	7 5 0
7			Michael Ryan, . . .	Silver Oliver, Esq. . .	House and land, . . .	6 1 10	3 10 0	0 10 0	4 0 0
8									
Total, . . .					164 1 4	87 6 0	9 10 0	96 16 0	
FANTANE, SOUTH (Ord. S. 34.)									
1		John Hickey, . . .	Capt. Robt. J. Otway, . . .	House, offices, and land,	25 3 0	15 5 0	1 10 0	16 15 0	
2		Roger Ryan, . . .	Capt. Robt. J. Otway, . . .	House, offices, and land,	57 1 12	30 0 0	4 0 0	34 0 0	
3		Thomas Carter, . . .	Capt. Robt. J. Otway, . . .	Land,	2 1 7	0 5 0	—	0 5 0	
—		Mary Tucker, . . .	Capt. Robt. J. Otway, . . .	Land,	0 1 26	0 1 0	—	0 1 0	
—		Matthias Stapleton, . . .	Capt. Robt. J. Otway, . . .	Land,	0 1 37	0 1 0	—	0 1 0	
—		Roger Hogan, . . .	Capt. Robt. J. Otway, . . .	Land,	1 0 0	0 2 0	—	0 2 0	
—		John Hickey, . . .	Capt. Robt. J. Otway, . . .	Land,	0 1 25	0 1 0	—	0 1 0	
—		Jeremiah Guinane, . . .	Capt. Robt. J. Otway, . . .	Land,	0 1 21	0 1 0	—	0 1 0	
—		William Wallace, . . .	Capt. Robt. J. Otway, . . .	Land,	0 2 0	0 1 0	—	0 1 0	
4		a	James Ardall, . . .	Capt. Robt. J. Otway, . . .	House, offices, and land,	67 2 21	35 0 0	4 10 0	39 10 0
—		b	Mrs. Ardall, . . .	James Ardall, . . .	House offices, & garden,	0 1 6	0 2 0	1 10 0	1 12 0
5			Thomas Carter, . . .	Capt. Robt. J. Otway, . . .	House, offices, and land,	28 1 10	17 0 0	2 0 0	19 0 0
Total, . . .					184 3 5	97 19 0	13 10 0	111 9 0	

There is a Cornelius Maher in Fantane North who is the occupant of Lot # 7 which is a little over 11 acres. The baptism records show that Patrick Connors, Mary Ryan's first husband, was also a resident of Fantane. The most probable scenario is that after the death of Patrick Connors his widow remained as the occupant of the land (Lot #7) and after she married Cornelius Maher they remained on the original Connors' farm.

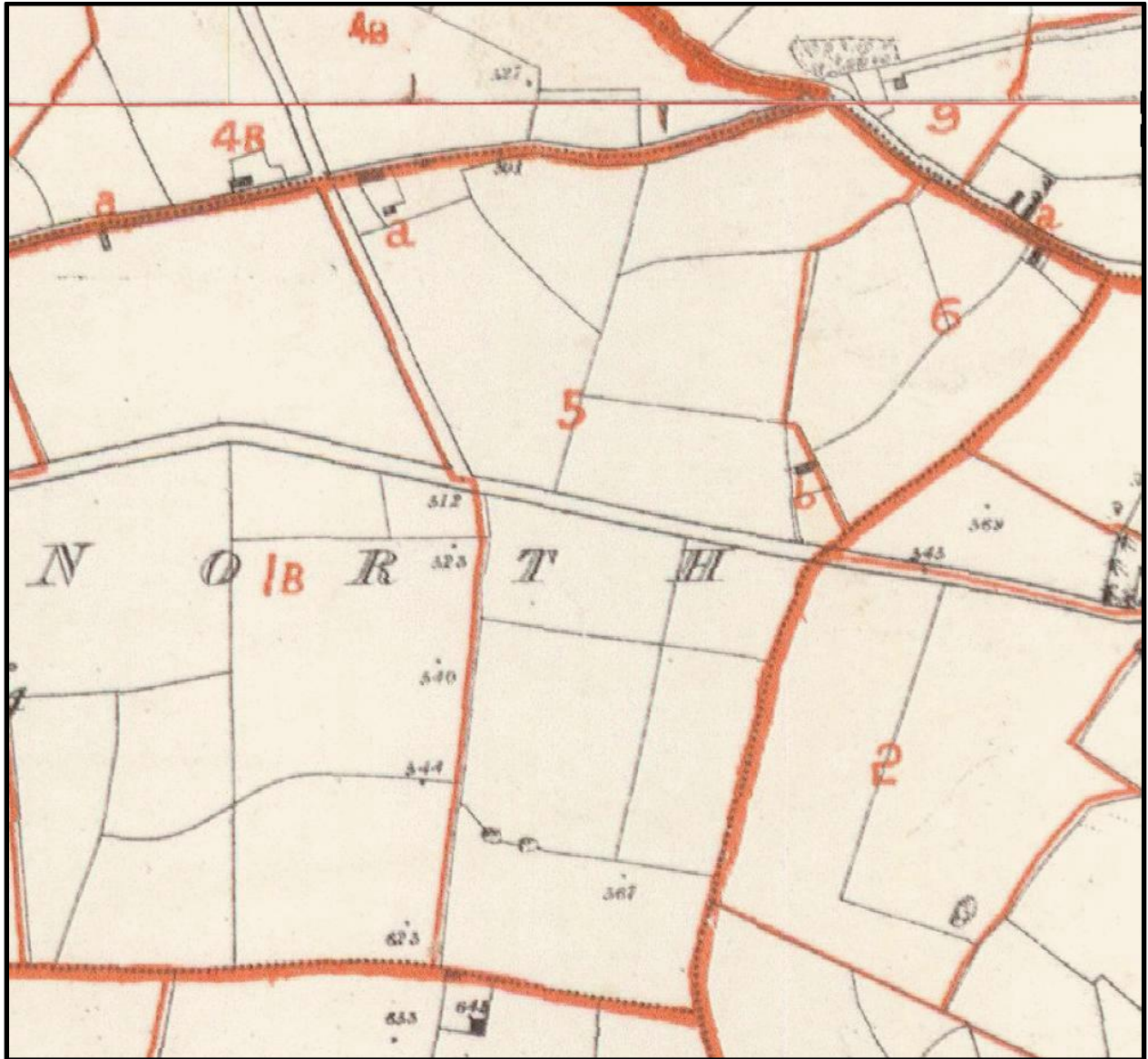

This is a valuation map of the eastern end of the townland of Fantane North, Glenkeen civil parish, Co. Tipperary. The Griffith's Valuation (GV) for the Thurles Poor Law Union (PLU) were published in 1850-1. The lot numbering found in the published GV doesn't match the numbering found on the valuation map shown above. Based on experience these maps found on the AskAboutIreland.com source represent the time period corresponding to the time of the cancellation of the 1st valuation book which was usually around 1865. The differences represent the large purchases and lot consolidation that took place between the time of the GV publication and the cancellation of the 1st valuation book. The numbering usually proceeded from left to right and top to bottom. Cornelius Maher's land was shown in the GV as Lot #7. In the map above there is no longer a Lot #7 however it was probably located in the region of Lots #5 and #6.

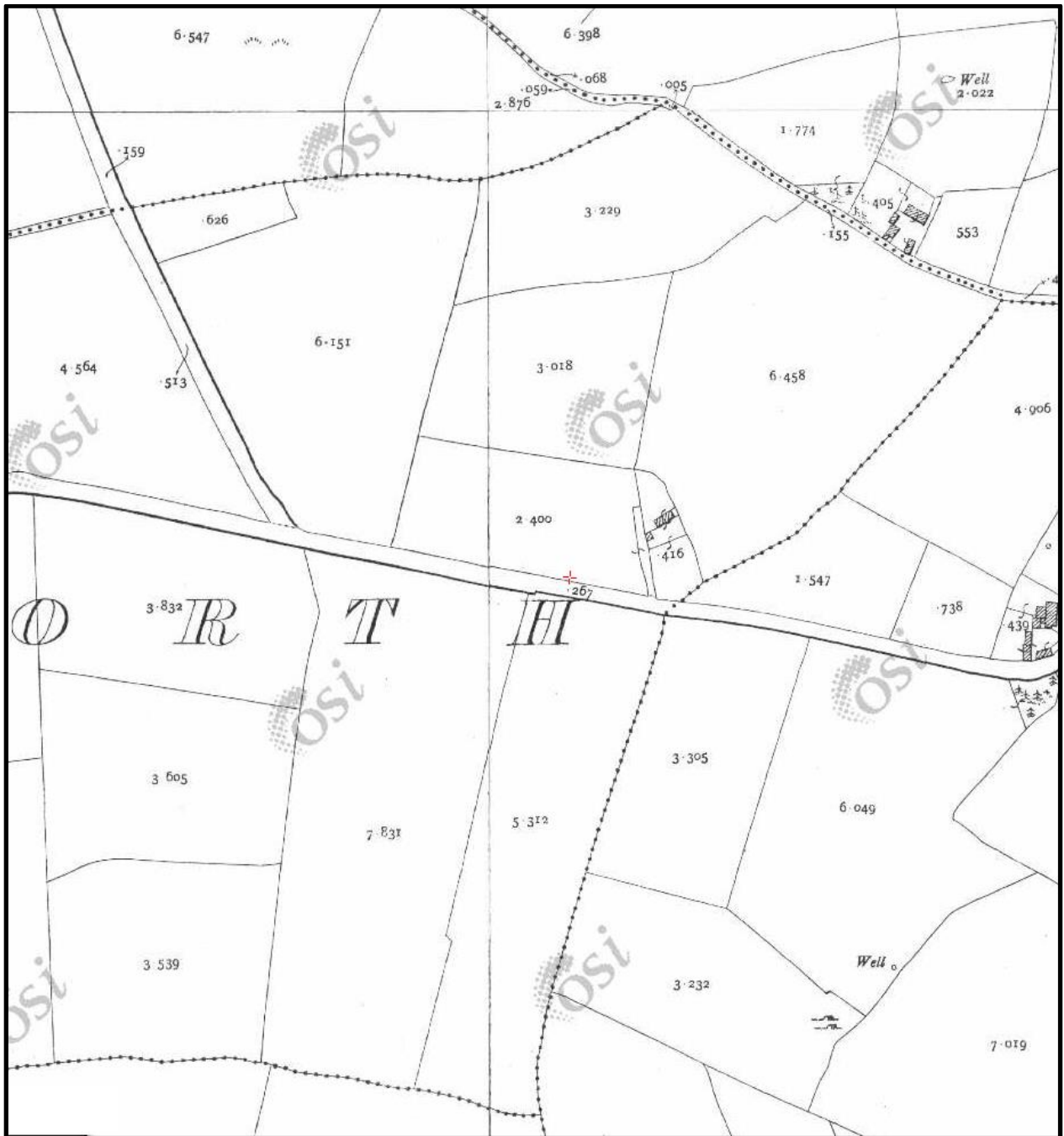

This is a townland map of the same area as shown in the valuation map on the previous page. This map date to circa 1880 and although it doesn't show the lot numbers or boundaries it does show the townland boundaries (dotted lines) and the sizes (in acres) of the various lots to a very high degree of precision.



This is a satellite image of the same portion of the townland of Fantane North, Glenkeen civil parish, Co. Tipperary, shown in the maps on the two previous pages. It is surprising that the field structures seen in the valuation maps from circa 1841 are still readily identified in a satellite image made over 175 years later.

Census Records - Bridget Maher

1860 NY Onondaga Lafayette M653-828-50 Img 7/65

Res 408, Family 426

John Spencer, 68, Farmer, Real Est \$3,000, Per Est \$2,000, England

Mary Ann Spencer, 60, House keeper, England

Bridget Mayher, 14, Ireland

1865 NY Onondaga Pompey ED01

Res 36, Frame \$50, Family 39

Mary Maghr, 54, Ireland, 3 children, Married twice, Wd

Thomas Conners, 24, Child, Ireland, S, Laborer, Alien, Now in Army

Bridget Maghr, 19, Child, Ireland, S

Emma Maghr, 12, Child, Onondaga Co, S

Res 37, Frame \$50, Family 40

Patrick Gleason, 40, Ireland, Married once, Married now, Naturalized, Owner of land,
Cannot read or write

Bridget Gleason, 41, Wife, Ireland, 5 children, Married twice, Married now

Thomas Ryan, 20, son, Ireland, S, Laborer

Margaret Ryan, 19, Child, Ireland, S

Catherine Ryan, 15, Child, Ireland, S

Patrick Gleason, 11, Child, Onondaga

John Gleason, 9, Child, Onondaga

Robert J. Conan, Jr.'s research papers from The Conan Archival Project contain an analysis of the Irish residents of Pompey found in the NYS 1855 census. (Binder_01-05, p. 3). His analysis shows that Cornelius Maher and his wife Mary had arrived in Pompey in 1851 and were living in the 1st District of Pompey at the time of the 1855 census.

The results from the 1865 Pompey census is useful in resolving several puzzles. Bridget Maher's mother Mary had come to the US. Mary's youngest child, Emma, was born in Onondaga Co. in about 1853. This would imply that she and her husband, Cornelius Maher, had come to Onondaga Co., probably Pompey, prior to Emma's birth. This is a more likely scenario than having Cornelius die in Ireland and a pregnant Mary travel to the US. Mary was married twice and her son Thomas Connor is from that first marriage.

If the 1860 Bridget "Mayher" is the daughter of Cornelius and Mary Maher then she was living separate from her family who should have been in the area (based on 1865 census analysis).

Lafayette - 1860 census - 65 images - No Cornelius or Mary Maher was found.

Pompey - 1860 census - 99 images - No Cornelius or Mary Maher was found.

Fabius - 1860 census - 60 images - No Cornelius or Mary Maher was found.

Fabius - 1855 census - 52 non-ag images - No Cornelius or Mary Maher was found.

The problem arising here, that of not finding Cornelius and Mary Maher in 1855, is due to the fact that Ancestry and the FamilySearch.org site, from The Church of Jesus Christ of Latter-day saints (The Mormons), are both missing the 1855 census returns for the town of Pompey, Onondaga Co., NY. Years ago I was able to access the Pompey returns via requesting it through the local LDS Family History Center in Austin, TX. Hence the microfilm does exist and the important information was found in the Conan Archives.

Thomas Maher and Mary O'Donnell

(s/o Thomas Maher and Mother)
(d/o Father and Mother)

Thomas Maher

b. 1817, Ireland (1865
Census)
b. 1824, Co. Cork (Gen)
d. 1887 (Gen)

= Mary O'Donnell

b. 1818, Ireland (1865 Census)
b. 1823, Co. Cork (Gen)
d. Dec 1, 1899, Lafayette @75 (ICC)

Mary Agnes Mahar (1)

b. Nov 1, 1859, Pompey, NY
baptized 2 November 1859.
Sponsor: Catherine Mahar
mar 1889
d. Feb 17, 1916, Syracuse, NY
bur at Pompey, NY

Alive in 1975 - Cincinnatus

Post Standard, Thursday 1980-02-28
Cortland - Mrs. Mabel F. Carr - 86

Sarah B. Maher (From Gen)

b. Sep 5, 1862, baptized 5 September
1862, at Pompey.
Sponsors: Daniel O'Brien and Mary
O'Donnell
mar 1898
d. Jul 27, 1945, East Syracuse, NY
bur Pompey, NY

= Lawrence Kinney

b. Aug 8, 1864, Pompey, NY
d. Sep 30, 1943
bur St. Mary's Cem, Pompey, NY

Mabel Kinney

b. 1894, NY
mar May 30, 1916
d. Feb 1980
No children

= George Carr

b. 1894
d. Mar 30, 1941,
Johnson City, NY
bur Willet Cem

= Kate Zimmer - 2nd Wife of L. Kinney

b. Mar 31, 1874
d. Oct 8, 1943, Willet, NY
bur Preble, NY
No children with Lawrence Kinney

= Philip McCarthy

b. Jan 18, 1867, Fly Creek, Otsego Co, NY
d. Oct 1, 1957, Cincinnatus, NY
bur Pompey Cemetery
No children

Source: Church records, St. James Catholic Church, Cazenovia, NY;
1865 Census; Gen = Descendants of Thomas Maher, by Gay Young, Mar 8, 2009

In the Gen document Thomas Maher's wife was Mary Kinney, b. 1823, Co. Cork, d. 1899. This surname is incorrect since their children's baptism records show that the name of Thomas Maher's wife was Mary O'Donnell. This raises the question: Do the birth and death dates belong to Mary Kinney or are they applicable to Mary O'Donnell? In other words, was the surname the only mistake or did the birth and death date come in with Mary Kinney. Suspiciously their daughter Mary Agnes married Lawrence Kinney, so that there was a Mary Kinney in the family. Perhaps it was a transcription error. Mary O'Donnell's census ages are consistent with being born in 1823.

No obituaries have been found for either Thomas or Mary O'Donnell Maher. The Fulton History Newspaper Archive was searched for any Mahar, Maher or Meagher deaths from 1880 to 1900. Since Thomas and Mary's daughters Mary and Sarah were buried in Pompey it can be assumed that their parents were also buried in Pompey. However, after searching the Find Graves site and a list of interments in the Immaculate Conception Cemetery, Pompey, NY, Thomas and Mary O'Donnell Maher were not found.

Thomas and Mary Age Analysis

	Thomas Maher		Mary O'Donnell	
	Age	Birth Yr	Age	Birth Yr
Gen		1824		1823
1860	37	1823	37	1823
1865	48	1817	47	1818
1870	46	1824	46	1824
1875	58	1817	50	1825
1880	50	1830	50	1830
1892		d. 1887	Missing	
1900				d. 1899

No endpoint records were found for either Thomas or Mary, i.e. birth, baptism or death certificates. Their approximate ages would place their baptisms prior to the commencement of the Upperchurch parish records. Both of these individuals are presumed to have died in Onondaga County (Pompey) and there should be death certificates for both at the Onondaga County Courthouse. In the unofficial category no obituaries were found in the available newspapers.

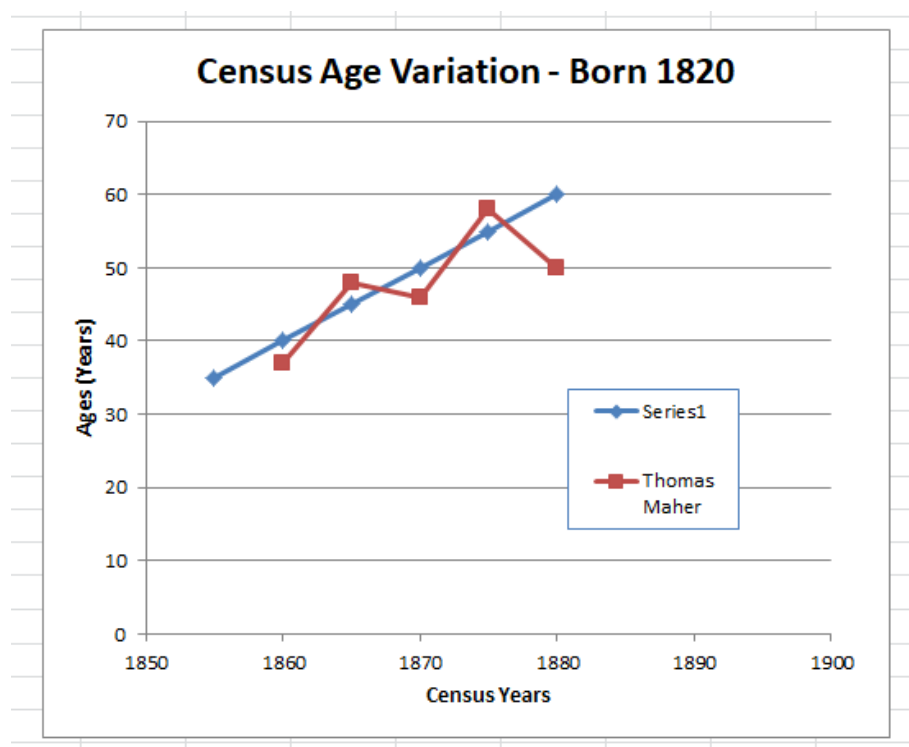

This graph shows the birth years estimated from the ages reported for Thomas Maher in the various census records (red line). Also shown are the ages in those same census years for someone born in 1820 (blue line). Although Thomas' census reported age varied through the

years they can be seen to be consistent with him having been born in 1820 compared with the birth year of 1824 in the Gen document.

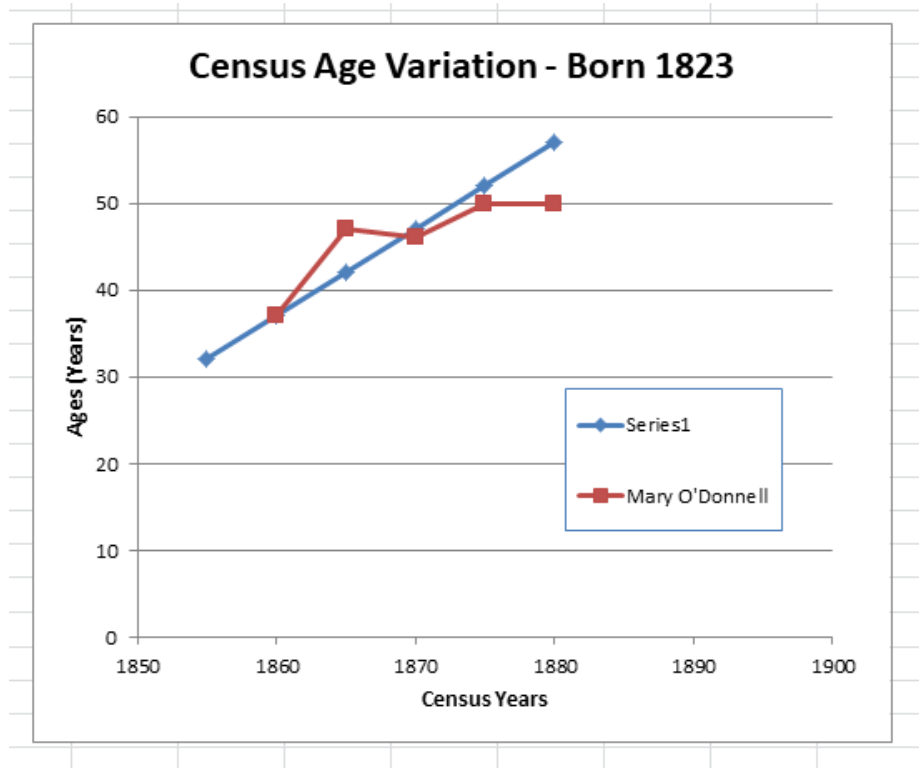

This graph shows the birth years estimated from the ages reported for Mary O'Donnell in the various census records (red line). Also shown are the ages in those same census years for someone born in 1823 (blue line). Although Mary's census reported age varied through the years they can be seen to be consistent with her having been born in 1823 which is the same birth year found in the Gen document.

John Maher and Mary Coonan

(s/o Thomas Maher and Mother)

(d/o Jeremiah Coonan and Winifred Walsh)

John Maher

b. 1830, Thurles
d. Prospect, Ontario, Canada
d. Nov 1894, Pompey, NY

Mary Coonan

b. Jan 1833, Thurles
mar in Upperchurch (Gen)
To US 1850 (1900 census)
d. Nov 21, 1911 (Gen)

Death date from Gay Young

Michael Maher

b. 1854, Pompey, NY
bap. Oct 2, 1854, Pompey, NY

John "Jack" Maher

b. Feb 26, 1857, Pompey, NY
d. Dec 19, 1908, Pompey, NY @51,
from (ICC)

Jeremiah "Jerry" Maher

b. Oct 2, 1859, Pompey, NY

This is the Cornelius Maher
who went to Toledo Ohio

Cornelius Maher

b. Jul 4, 1861, Pompey, NY
d. between 1920-1930, Ohio

= **Unknown (1)**

d. before 1900, Ohio

= **Mary E. Quinlan (2)**

b. 1870, Ohio
mar. 1900
Alive in Toledo in 1930

Death date from Gay Young

Winifred Maher

b. Mar 30, 1863
d. 1888

Thomas F. Maher

b. Mar 1, 1865, Pompey, NY

Bridget Agnes Maher

b. Aug 24, 1868

= **Thomas Atkinson**

b. 1866, Syracuse, NY

Patrick Lawrence Maher

b. Mar 1871

Mary De Anne Maher

b. 1873, NY
mar. 1905

= **Henry J. Skinner**

b. 1875, PA

In the 1910 census Mary Coonan Maher stated that she had given birth to 9 children, only 5 of whom were still alive. Ten years earlier, in 1900, Mary had stated that she had given birth to only 7 children and only 4 were still alive. These census records together would indicate that Mary Ann Maher is probably Mary De Anne Maher and Lawrence Maher shown in the Thomas Maher Genealogy from Gay Young is probably Patrick Lawrence Maher.

No obituary has been found for Mary Coonan Maher.

John Maher and Mary Coonan Age Analysis

	John Maher		Mary Coonan	
	Age	Birth Yr	Age	Birth Yr
Gen		1830		Jan 1833
1860	32	1828	24	1836
1865	42	1823	35	1830
1870	50	1820	49	1821
1875	50	1825	40	1835
1880	63	1817	45	1835
1892	70	1822	56	1836
1900		d. 1894	71	Jan 1829
1910			75	1835
1915				d. 1911

No endpoint records were found for either Thomas or Mary, i.e. birth, baptism or death certificates.

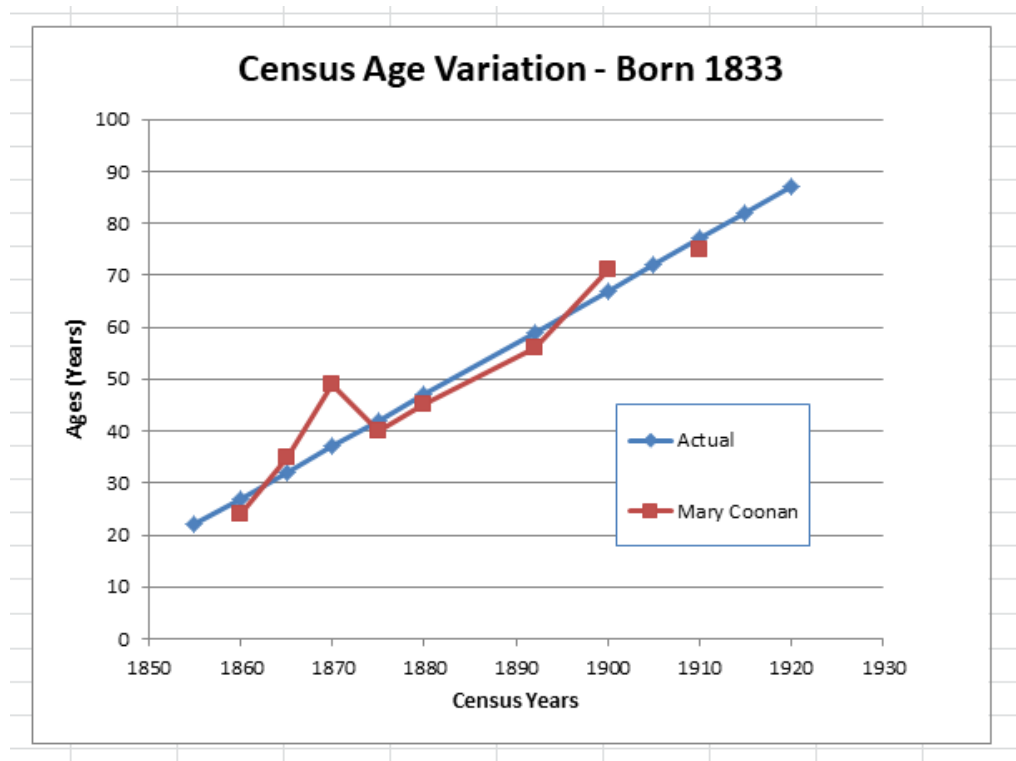

This graph shows the birth years estimated from the ages reported for Mary Coonan Maher in the various census records (red line). Also shown are the ages in those same census years for someone born in 1833 (blue line). Although Mary's census reported age varied through the years they can be seen to be consistent with her having been born in 1833 as found in the Gen document.

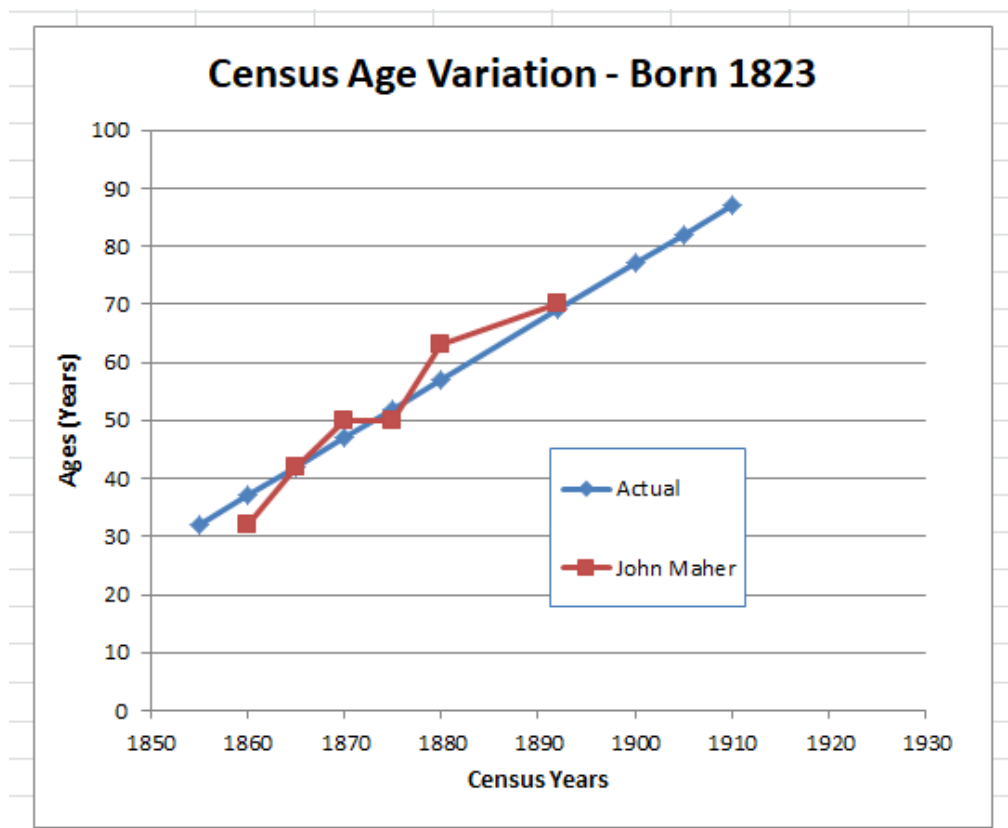

A similar age analysis applied to the census ages of John Maher shows that they are consistent with a birth year of 1823. This is seven years less than the birth year of 1830 found in the Gen document.

Extra Records

Mary Mahar, d. July 31, 1899, Pompey, age 65 years, (b. 1834)

There is a Mary Mahar born 1826, died 1895, buried in St. Mary's Cemetery, DeWitt, Onondaga County, NY

References:

(ICC) - IMMACULATE CONCEPTION CHURCH, POMPEY, NEW YORK, Death Notices 1899-1909

Source: 9 ½" x 7 ½" plain, coverless copy book containing death records 1899-1909 of Immaculate Conception Church, Pompey, New York.

Copied May 1996 by Virginia Cameron, Fabius Village Historian from original records; copied again October 2003 by Kathy Crowell, courtesy of Virginia Cameron.

The Conan Archival Project - The Genealogy Research Papers of Robert J. Conan, Jr., Ph.D.
<http://mcgrathsearch.com>